

**Metal Building Software, Inc.**

5950 14th St. S.

Fargo, North Dakota 58104

SHIPPING LIST FOR

**Metal Building Contractor**

www.MBSweb.com

Fargo, North Dakota 58104

**Your New Building**

1234 Opportunity Boulevard

Fargo, North Dakota 58104

BUILDING DATA

Width (ft) = 60  
Length (ft) = 60  
Eave Height (ft) = 20  
Roof Slope (rise/12) = 1.0:12  
Dead Load (psf) = 2  
Collateral (psf) = 1  
Roof Live Load (psf) = 20  
Frame Live Load (psf) = 12  
Snow Load (psf) = 35  
Ground Snow Load (psf) = 50  
Wind Speed(mph) = 115  
Wind Code = IBC 12  
Closed/Open = Closed  
Exposure = C  
Importance - Wind = 1  
Seismic Design Category = A  
Importance - Seismic = 1

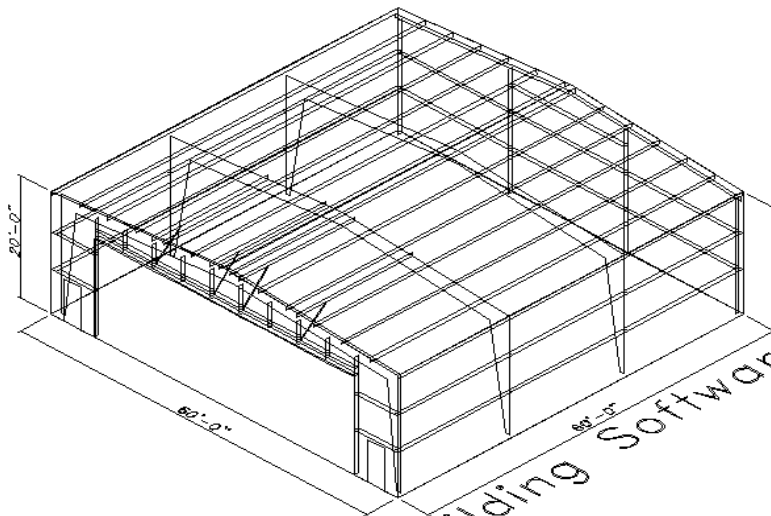

Metal Building Software, Inc.



**Metal Building Software, Inc**  
 5950 14th Street South  
 Fargo, North Dakota 58104

**COLUMNS & RAFTERS**

Date 2/13/14  
 Job Id 20614

Customer Metal Building Contractor  
 Building Size 60'-0" x 60'-0" x 20'-0"  
 SHEET 1 OF 9

QTY	MARK	DESCRIPTION	PART	LENGTH	WEIGHT
2	RF1-1	RF Column		232.58	821.80
1	RF1-2	RF Rafter		324.25	766.50
1	RF1-3	RF Rafter		324.25	766.50
4	RF2-1	RF Column		232.51	2410.40
4	RF2-2	RF Rafter		312.09	3134.40
1	HB-1	Header Beam	W8X10	116.25	96.90
2	HB-2	Header Beam	W8X10	119.50	199.20
1	HB-3	Header Beam	W8X10	59.50	49.60
1	HB-4	Header Beam	W8X10	116.25	96.90
2	BB-1	Back Brace	L3X3X316	76.39	47.20
2	BB-2	Back Brace	L3X3X316	82.22	50.80
1	EC-1	EW Column	W08661	237.47	382.60
2	EC-2	EW Column	W08541	44.47	107.40
2	EC-3	EW Column	W08541	49.47	120.60
2	EC-4	EW Column	W08541	54.47	127.40
2	EC-5	EW Column	W08541	59.47	140.60
1	EC-6	EW Column	W08661	237.47	382.60
2	EC-7	EW Column	C82512	223.61	198.20
1	EC-8	EW Column	W08541	242.94	257.10
1	EC-9	EW Column	W08541	242.94	257.10
1	ER-1	EW Rafter	W08541	361.00	390.90
1	ER-2*	EW Rafter	W08541	361.00	390.90

Total Weigh: 11195.60



**Metal Building Software, Inc**  
 5950 14th Street South  
 Fargo, North Dakota 58104

**PURLINS & GIRTS**

Date 2/13/14  
 Job Id 20614

Customer Metal Building Contractor  
 Building Size 60'-0" x 60'-0" x 20'-0"  
 SHEET 2 OF 9

QTY	MARK	DESCRIPTION	PART	DWG	PITCH	PUNCH	LENGTH	WEIGHT
24	P-1	Roof Purlin	Z82512			B-B	277.50	2536.40
12	P-2	Roof Purlin	Z82514			B-B	315.50	1009.60
2	P-3	Roof Purlin	Z82512	P-3		WK-WK	233.50	177.80
2	P-4	Roof Purlin	Z82512	P-4		WK-WK	233.50	177.80
1	E-1	Eave Strut	E85314L1	E-1	1	??-??	239.50	87.00
2	E-2	Eave Strut	E85314L1	E-2	1	??-??	239.50	174.00
1	E-3	Eave Strut	E85314L1	E-3	1	??-??	239.50	87.00
1	E-4	Eave Strut	E85314L1	E-4	1	??-??	239.50	87.00
1	E-5	Eave Strut	E85314L1	E-5	1	??-??	239.50	87.00
4	G-1	EW Girt	Z82516			EP-EP	78.00	67.60
2	G-2	EW Girt	C82516			EP-EP	53.50	23.20
7	G-3	EW Girt	C82516			EP-EP	54.00	81.90
4	G-4	EW Girt	Z82512			EP-EP	226.00	344.30
1	G-5	EW Girt	Z82512			EP-EP	234.00	89.10
2	G-6	EW Girt	Z82514			EP-EP	234.00	124.80
8	G-7	SW Girt	Z82516			A-A	253.50	439.40
4	G-8	SW Girt	Z82516			A-A	267.50	231.80

Total Weight: 5825.70



**Metal Buidling Software, Inc**

5950 14th Street South  
 Fargo, North Dakota 58104

**SHEETING**

Date	2/13/14
Job Id	20614

Customer	Metal Building Contractor
Building Size	60'-0" x 60'-0" x 20'-0"
SHEET	3 OF 9

QTY	MARK	DESCRIPTION	PART	COLOR	PITCH	LENGTH	WEIGHT
40	RS-1	Roof Sheet	HR26 45	WT		362.50	3233.50
2	ESL-1	L_EW Sheet	HR26 45	BL		241.00	107.50
2	ESL-2	L_EW Sheet	HR26 45	BL		244.00	108.80
2	ESL-3	L_EW Sheet	HR26 45	BL		247.00	110.20
2	ESL-4	L_EW Sheet	HR26 45	BL		40.50	18.10
2	ESL-5	L_EW Sheet	HR26 45	BL		43.50	19.40
2	ESL-6	L_EW Sheet	HR26 45	BL		46.50	20.70
2	ESL-7	L_EW Sheet	HR26 45	BL		49.50	22.10
2	ESL-8	L_EW Sheet	HR26 45	BL		52.50	23.40
2	ESL-9	L_EW Sheet	HR26 45	BL		55.50	24.80
2	ESL-10	L_EW Sheet	HR26 45	BL		58.50	26.10
2	ESR-1	R_EW Sheet	HR26 45	BL		241.00	107.50
2	ESR-2	R_EW Sheet	HR26 45	BL		244.00	108.80
2	ESR-3	R_EW Sheet	HR26 45	BL		247.00	110.20
2	ESR-4	R_EW Sheet	HR26 45	BL		250.00	111.50
2	ESR-5	R_EW Sheet	HR26 45	BL		253.00	112.80
2	ESR-6	R_EW Sheet	HR26 45	BL		256.00	114.20
2	ESR-7	R_EW Sheet	HR26 45	BL		259.00	115.50
2	ESR-8	R_EW Sheet	HR26 45	BL		262.00	116.90
2	ESR-9	R_EW Sheet	HR26 45	BL		265.00	118.20
2	ESR-10	R_EW Sheet	HR26 45	BL		268.00	119.50
20	SSF-1	F_SW Sheet	HR26 45	BL		240.00	1070.40
20	SSB-1	B_SW Sheet	HR26 45	BL		240.00	1070.40
40	RP-1	Roof Liner	PBR26 45	WT		361.00	3220.10
2	EPL-1	L_EW Liner	PBR26 45	WT		231.00	103.00
2	EPL-2	L_EW Liner	PBR26 45	WT		234.00	104.40
2	EPL-3	L_EW Liner	PBR26 45	WT		237.00	105.70
2	EPL-4	L_EW Liner	PBR26 45	WT		32.00	14.30
2	EPL-5	L_EW Liner	PBR26 45	WT		35.00	15.60
2	EPL-6	L_EW Liner	PBR26 45	WT		38.00	16.90
2	EPL-7	L_EW Liner	PBR26 45	WT		41.00	18.30
2	EPL-8	L_EW Liner	PBR26 45	WT		44.00	19.60
2	EPL-9	L_EW Liner	PBR26 45	WT		47.00	21.00
2	EPL-10	L_EW Liner	PBR26 45	WT		50.00	22.30
2	EPR-1	R_EW Liner	PBR26 45	WT		231.00	103.00
2	EPR-2	R_EW Liner	PBR26 45	WT		234.00	104.40
2	EPR-3	R_EW Liner	PBR26 45	WT		237.00	105.70
2	EPR-4	R_EW Liner	PBR26 45	WT		240.00	107.00
2	EPR-5	R_EW Liner	PBR26 45	WT		243.00	108.40
2	EPR-6	R_EW Liner	PBR26 45	WT		246.00	109.70
2	EPR-7	R_EW Liner	PBR26 45	WT		249.00	111.10
2	EPR-8	R_EW Liner	PBR26 45	WT		252.00	112.40

**Total Weight: 11513.40**



**Metal Buidling Software, Inc**

5950 14th Street South  
Fargo, North Dakota 58104

**SHEETING**

Date	2/13/14
Job Id	20614

Customer	Metal Building Contractor		
Building Size	60'-0" x 60'-0" x 20'-0"		
SHEET	4	OF	9

QTY	MARK	DESCRIPTION	PART	COLOR	PITCH	LENGTH	WEIGHT
2	EPR-9	R_EW Liner	PBR26 45	WT		255.00	113.70
2	EPR-10	R_EW Liner	PBR26 45	WT		258.00	115.10
20	SPF-1	F_SW Liner	PBR26 45	WT		239.00	1065.90
20	SPB-1	B_SW Liner	PBR26 45	WT		239.00	1065.90

**Total Weigth: 2360.60**

Colors: BL - Blue  
WT - White



**Metal Buidling Software, Inc**

5950 14th Street South  
Fargo, North Dakota 58104

**CLIPS**

Date	2/13/14
Job Id	20614

Customer	Metal Building Contractor		
Building Size	60'-0" x 60'-0" x 20'-0"		
SHEET	5	OF	9

QTY	MARK	DESCRIPTION	PART	ANGLE	THICK	WIDTH	LENGTH	WEIGHT
4	f1	Str-Brc Plt		-5.00	0.1880	5.00	12.00	12.80
4	r1	Cor-Grt3 Plt	EGSG1	0.00	0.1880	5.75	10.00	48.80

**Total Weigth: 61.60**



**Metal Building Software, Inc**  
 5950 14th Street South  
 Fargo, North Dakota 58104

**ANGLES**

Date	2/13/14
Job Id	20614

Customer	Metal Building Contractor		
Building Size	60'-0" x 60'-0" x 20'-0"		
SHEET	6	OF	9

QTY	MARK	DESCRIPTION	PART	DWG	COLOR	THICK	LENGTH	WEIGHT
4	Angle	SHEET CLIP	SHEETCLP	Angle	RO	0.0610	7.50	1.90
2	FB29	EW Flg Brc	B2514	FB29		0.0700	29.00	4.50
2	FB33	RF Flg Brc	B2514	FB33		0.0700	33.00	5.20
4	FB36	RF Flg Brc	B2514	FB36		0.0700	36.00	11.30
2	FB37.5	RF Flg Brc	B2514	FB37.5		0.0700	37.50	5.90
4	FB38.5	RF Flg Brc	B2514	FB38.5		0.0700	38.50	12.10
6	FB39	RF Flg Brc	B2514	FB39		0.0700	39.00	18.40
4	FB40.5	RF Flg Brc	B2514	FB40.5		0.0700	40.50	12.70
4	FB41.5	RF Flg Brc	B2514	FB41.5		0.0700	41.50	13.00
4	FB44.5	RF Flg Brc	B2514	FB44.5		0.0700	44.50	14.00
4	RA-1	Rake Angle	B6314	RA-1	RO	0.0750	360.00	163.20
4	RA-1	Rake Angle	B6314	RA-1	RO	0.0750	0.25	0.11
6	L6x3	Liner Angle	B6314	L6x3	RO	0.0750	240.00	244.80
10	L4x2	Base Angle	B4214	L4x2	RO	0.0750	240.00	306.00
4	SA-1	Corner Angle	B314	SA-1	RO	0.0750	239.00	108.30

**Total Weighth: 921.41**

Colors: RO - Red Oxide



**Metal Buidling Software, Inc**  
 5950 14th Street South  
 Fargo, North Dakota 58104

**TRIM**

Date 2/13/14  
 Job Id 20614

Customer Metal Building Contractor  
 Building Size 60'-0" x 60'-0" x 20'-0"  
 SHEET 7 OF 9

QTY	MARK	DESCRIPTION	PART	COLOR	PITCH	THICK	LENGTH	WEIGHT
12	HRLET	LARGE EAVE TRIM HR	HRLET	RD		0.0180	123.00	69.80
4	HRCO14	RAKE TRIM HR	HRCO14	RD		0.0180	171.00	48.60
4	HRCO16	RAKE TRIM HR	HRCO16	RD		0.0180	195.00	55.40
4	HRIC	INSIDE CORNER TRIM H	HRIC	PL		0.0180	123.00	36.20
2	HRJT3	HEAD TRIM HR	HRJT3	RD		0.0180	42.00	15.10
4	HRJA7	JAMB TRIM HR	HRJA7	RD		0.0180	87.00	35.10
4	HRJA7	JAMB TRIM HR	HRJA7	PL		0.0180	87.00	35.10
4	HRJT14	JAMB TRIM HR	HRJT14	PL		0.0180	171.00	41.80
4	HRJT16	JAMB TRIM HR	HRJT16	PL		0.0180	195.00	47.70
2	HRJT12	HEAD TRIM HR	HRJT12	PL		0.0180	147.00	18.00
6	HRJT16	HEAD TRIM HR	HRJT16	PL		0.0180	195.00	71.60
12	HRJA20	JAMB TRIM HR	HRJA20	PL		0.0180	243.00	66.60
4	HRCO20	CORNER TRIM HR	HRCO20	RD		0.0180	243.00	92.00
6	HRERC	RIDGE CAP HR	HRERC	WT		0.0180	123.00	6.00

**Total Weighth: 639.00**

Colors: WT - White  
 RD - Red  
 PL - Plain





**Metal Buidling Software, Inc**

5950 14th Street South  
Fargo, North Dakota 58104

**BRACING & SEALANT**

Date	2/13/14
Job Id	20614

Customer	Metal Building Contractor		
Building Size	60'-0" x 60'-0" x 20'-0"		
SHEET	8	OF	9

QTY	MARK	DESCRIPTION	PART	DIA	FAB LENGTH	LENGTH	WEIGHT
40		I/S Closure	CLINHR		1.00	36.00	20.00
42		O/S Closure	CLOUTHR		1.00	36.00	21.00
29		SEAL TAPE	BUT4538		0.38	540.00	58.00

**Total Weigh:** 99.00



**Metal Buidling Software, Inc**  
 5950 14th Street South  
 Fargo, North Dakota 58104

**FASTENERS**

Date 2/13/14  
 Job id 20614

Customer Metal Building Contractor  
 Building Size 60'-0" x 60'-0" x 20'-0"  
 SHEET 9 OF 9

QTY	DESCRIPTION	PART	COLOR	TYPE	DIA	LENGTH	WEIGHT
29	Bolts	H625X150		A325	0.6200	1.50	10.70
88	Nuts	A325N58		A325	0.6200		9.70
630	Bolts	M50X125		A307	0.5000	1.25	88.20
630	Nuts	A307N12		A307	0.5000		18.90
8	Bolts	H625X200		A325	0.6200	2.00	3.00
51	Bolts	H625X250		A325	0.6200	2.50	18.20
63	Bolts	H50X125		A325	0.5000	1.25	11.30
63	Nuts	A325N12		A325	0.5000		3.80
49	Bolts	H75X250		A325	0.7500	2.50	27.00
49	Nuts	A325N34		A325	0.7500		8.80
3250	Metal To Metal	12X1.25	WT			1.25	52.00
1500	Metal To Metal	12X1.25	BL			1.25	24.00
500	7/8 LAP TEK MTM	14-.875	RD			0.88	8.00
2370	7/8 LAP TEK MTM	14-.875	WT			0.88	37.90
250	Metal To Metal	12X1.25	RD			1.25	4.00
500	7/8 LAP TEK MTM	14-.875	BL			0.88	8.00
500	7/8 LAP TEK MTM	14-.875	WT			1.25	8.00
250	Nail Drive Anchor	Drivepin	GZ			1.25	4.00

Total Weigth: 345.50

Colors: GZ - Galvanized  
 BL - Blue  
 WT - White  
 RD - Red